

FOR OUR GUESTS

We are glad you chose to worship with us today! We want to make your experience with us as easy and enjoyable as possible. The following information will help you to know what to expect today.

Please take advantage of our children's programs:

Nursery (ages 0 through 2 yrs.)

A staffed, teaching nursery is located out the auditorium doors to the right.

Jesus' Farm (Ages *3 yrs. - K)

Jesus Farm is our pre-school program, offered during both hours, to help children know that God loves & cares for us. Every activity is geared to the child's learning level. It is located out the auditorium doors to the left. Your child may be checked in at the wagon. (*potty trained)

rEVOLVe (Grades 1 - 5)

rEVOLVe is our elementary-age program located in the lower level of the fellowship hall. Bring your child down at 9:00 for Sunday School. Children experience a time of worship & an environment to develop a relationship with Jesus Christ through different activities.

The Offering - It is a privilege to give back to God a portion of the material blessings He has given us. Offering boxes are located on the walls at the back of the auditorium, you can give online @ ripleycoc.com, or when the plates are passed.

Communion - We choose to offer the Lords' Supper each Sunday for all Christians to share. This is done to provide an opportunity to obey Christ to commune "in remembrance" of His death on the cross. Use this quiet time to draw close to the sacrificial Savior. Emblems will be passed during the service or prepackaged units can be picked up at the table in the foyer.

Decision and Dedication - Times for public responses to God are included in our worship. If you believe that Jesus is the Son of God, has the power to be your Savior, and has the right to be your Lord, this is an invitation for you to come to the front at the invitation song to announce your belief publicly and to accept Christ by immersion in water (baptism). If you are an

immersed believer in Jesus, and desire to be an active member of this body of believers, then come to affirm your faith publicly and express that desire. Responses for rededication and prayer are also encouraged by coming to the front at the invitation song.

If you would like further information about either of these decisions, feel free to schedule an appointment with one of our staff members. Individuals may make these decisions throughout the week and need not take place in the worship service.

If you need additional information or assistance, please ask an usher or greeter. They are here to assist you.

Ripley Church of Christ

9:00 am Sunday School
10:15 am Worship

Ph. 330-567-2320 www.ripleycoc.com

For more detailed information about our church, service opportunities or ministries, stop by our welcome center or visit us on the web. You'll find access to sermons, resources, calendar, and more.

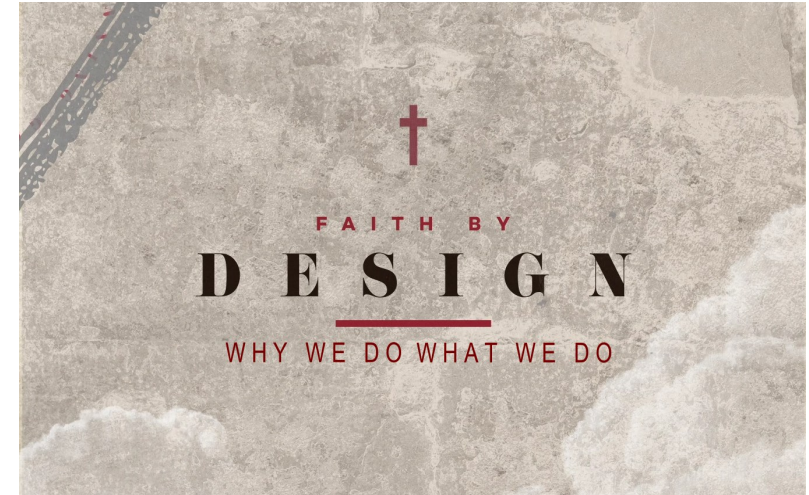

Every once in awhile it is good to remind ourselves of who we are. The Church is not a building. We, people, human beings, warts and all, we are the Lord's Church and we are here for a purpose. Faith by Design. A study of why we do what we do.

April 28, 2024

Tom Benter
Senior Minister
Mike South
Youth Minister

Jeremiah Stivers
Associate Minister
Ariel Stivers
Children's Ministry Coordinator

Message Notes

Faith by Design We Baptize

TEXT: Romans 6:1-8

We come to a topic that, while it is foundational, is one of the most controversial issues within Christianity.

- j_____ with Christ
- baptized i_____ Christ's death / results in n_____ l_____
- leads to being u_____ with Jesus in his r_____
- put to death the o_____ s_____
- f_____ us from s_____
- L_____ with Christ

I. THE R_____ IS S_____— vs 3

“baptized into Christ Jesus”

- The C_____ is in C_____ Phil.1:1; 1 Pet 5:14; 1 Cor. 1:30
- C_____ is in the C_____ 2 Cor. 13:5; Rom 8:10; Col 1:27

Critical question: _____?

II. THE R_____ IS S_____— vs 5

‘baptizo’— _____

- The m_____ and the p_____ go hand in hand.

CONCLUSION:

“every one of you“ — Acts 2:38

Exceptions

1. _____
2. _____

Conversions: ACTS

Preaching	Faith	Repentance	Confession	Baptism	Salvation
Pentecost Acts 2:14-41	NI	37-38	NI	38-41	38-47
Samaria Acts 8:5-13	12	NI	NI	12-13	NI
Eunuch Acts 8:35-39	36-37	NI	37	38	39
Saul / Paul Acts 9:17-18	NI	NI	NI	18	22:16
Cornelius Acts 10:34-48	43	NI	NI	48	43
Lydia Acts 16:13-15	14	NI	NI	15	15
Jailor Acts 16:30-34	31	NI	NI	33	34

Create your **KidCheck** SECURE CHECK-IN account using one of kiosks located in the Nursery, outside Jesus' Farm, or Revolve areas. Each week when you check your child into our programs you will receive two stickers (place one on your child and retain one to pick up the child following services). Please line up outside respective children's areas (Revolve parents downstairs) as we dismiss children one at a time.

free account

ATTENTION NURSERY/JESUS FARM/REVOLVE PARENTS: Parents need to create a Kid Check account using one of kiosks located in the Nursery, outside Jesus' Farm, or Revolve areas. Each week when you check your child into our programs you will receive two stickers (place one on your child and retain one to pick up the child following services). Please line up outside respective children's areas (Revolve parents downstairs) as we dismiss children one at a time.

Welcome / Congratulations— The following individuals have made their confessions of faith and been baptized at RCC recently: Tim Savage and Dylan Graveley.

This Week

Today:	9:00a	Sunday School/Adult Bible Fellowship
	10:15a	Worship
		Jesus' Farm & rEVOLVe Children's Program
	12:00	Rooted Luncheon
	5:00	Youth Sponsor Meeting
	6:00p	Launch Youth Group
		Women's Bible Study
Tue:	6:30p	American Heritage Girls
Wed:	7:00p	Men's Bible Study
Thurs:	6:30p	Mixed Small Group Bible Study
Sat:	10:00a	Me and My Gal Brunch

ABF Classes / Locations

9:00a
Adult Study: *Isaiah* F3
Youth Sunday School: Basement
Women's Class, Conf. Room
College / Young Adults: Choir Room
6:00 p
Ladies' Bible Study: Conf Rm

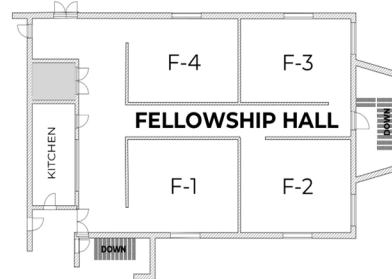

Members—Regular Attenders—Guests: Please complete a **Connect Card**, located on the back of the pews, and deposit in the offering plates each Sunday.

April 21 Giving \$6,619.45 Budget \$7,692.31

Events / Misc Information

Tonight! Women's Bible Study at 6pm In Conference Room

We will be discussing the book *Praying the Bible* by Donald S. Whitney. All women are welcome! Questions? See Ariel Stivers or Debbie Miller.

Me & My Gal Brunch—May 4 10:00AM

Join us for a brunch with other ladies for a time of fellowship, devotion, and craft. We will be blessing the Pregnancy Care Center in Wooster, so please bring an item to donate.



Ministry Fair—May 5 Directly following service, come learn what is happening in our church & discover new ways to get involved. A friendly time of fellowship and a fun meal to go!

5th Grade "Sneak Peek" Sunday: May 5th

Acres of Fun trip for all 5th, 6th & 7th graders. We will leave from the church at 2:30 pm and be back at 5:30 pm. 5th graders are invited to stay for Dinner & Launch Youth Group in the Fellowship Hall from 6-8pm.

Graduation Sunday: May 19th

If you have a student graduating from high school or college that you would like recognized in service, please see Mike South for questionnaire. Return it to Mike completed, with graduate photos, by May 5th.



Re/new (Formerly Senior Saints)—May 19-24

Registration is presently open (online or mail-in). RCC provides a scholarship of 50% for each adult who registers with RCC. Information flyers are available at the Connection Center.

Round Lake Christian Camp—RCC

youth/children receive a 50% discount. Contact Ariel Stivers / Mike South for a RCC Code prior to registering online.



Offering / Communion Servers

- Please **wait** till the conclusion of the Invitation Song before exiting your seat / auditorium.